

**Developer**  
Lakozy Builders LLP.

**Site Address:**  
Anchor Park, Sector- F,  
Evershine City Last Stop,  
Near Achole Talao,  
Vasai (E).  
Tel.: 0250 - 6585060 / 0250 - 6586050  
Contact.: 9004 36 54 10 / 9004 36 54 12

E-mail: [info@anchorrealty.in](mailto:info@anchorrealty.in)  
[www.anchorrealty.in](http://www.anchorrealty.in)

**Corporate Address:**  
Level 13, Tower B,  
Peninsula Business Park,  
Senapati Bapat Marg,  
Lower Parel (W), Mumbai - 400 013  
Tel.: +91 22 3003 6565

\*Disclaimer:  
The information in this brochure is indicative of the kind of development that is proposed. Subject to the approval of the authorities or in the interest of continuing improvements, the developer reserves the right to change the layout, plans, specifications, features, brands used or amenities without prior notice or obligation. The amenities shown inside the images in the brochure are purely indicative. All amenities, fixtures, brands, tiles etc. mentioned in the brochure OR displayed in the show / sample flats are subject to availability and quality checks of the specific design at the time of execution and implementation.

**ANCHOR**  
**PARK**

**SMS 'PARK' to 56161**





## THE ANCHOR GROUP

Synonymous with trust, quality and safety, the Anchor Group is a rapidly evolving enterprise with a goal to transform itself by offering lifestyle solutions in FMCG, Real Estate, Wiring Devices, Writing Instruments, Paints, Health Care, Stationery, Leasing and Finance. With a promising legacy and an incredible brand equity, the group is all set to diversify its wings across businesses, bringing in more light and smiles to the nation.





A Project by **ANCHOR**  
REALTY

Nurturing dreams and providing our customers with the best value has been our driving force as we have continued to redefine benchmarks in industry. A conviction to deliver based on the principles of ethical business practices while high lighting customer value proposition is what puts us ahead. Anchor Realty has been able to successfully merge aesthetic and utility concepts by using the latest technologies to form structures that define the city' landscape.

At Anchor Realty every nuance is dealt with precision, ensuring value that lasts a lifetime. This is only possible due to our management team which only allows the best man-power, construction methods and raw material to be selected.

Our testimony is our work and our completed projects can be seen at prime locations such as Walkeshwar, Altamount road, Vile parle, Chembur, Ghatkopar, Thane and Vasai.





## SAMPLE FLAT READY



## PROPOSED AMENITIES OF PROJECT

- Convenient from both Vasai & Nallasopara Stations
- Breathtaking views of Achole Talao from select flats
- Luxurious 1 BHK, 2 BHK Flats with Modern Interiors
- Retail Shops on Ground floor
- Beautiful Elevations
- Gymnasium
- Children's Play Area
- Basketball Court
- Table Tennis
- Senior Citizen Area
- Walking Track
- Landscape Garden
- Ample Car Parking Space in Stilt/Open area
- Heighted Entrance Lobby
- Modern Fire Fighting system
- Generator back up for Common Areas
- High-Speed Elevators
- Billiards Room
- Games Room
- Guard house
- Meditation & Yoga area
- Rain Water Harvesting





## 1 BHK 3D VIEW



### LIVING & BED ROOM

- 2' X 2' Mirror Finish Vitrified Flooring
- Decorative Flush Doors With Both Sides Laminate For Entrance & Bedroom
- Designer Fall Ceiling in living room
- Concealed Spot Light Fixtures & Points
- Gypsum Finished Walls & Ceiling
- Plastic Paint On Walls
- Aluminum Anodized Sliding Windows
- Great White Polycab Cables
- Great White Fiana Modular Switches
- Door Bell

### KITCHEN

- Modular Kitchen With Stainless Steel Trolleys & Designer Cabinets
- 2' X 2' Mirror Finish Vitrified Flooring
- Digital Print Technology Wall Tiles Up To Door Level
- 24" Granite Main Kitchen Platform With Service platform
- Stainless Steel Sink With Sink Cock
- Points For Refrigerator, Mixer/oven, Exhaust Fan & Washing Machine

## 2 BHK 3D VIEW



### BATHROOM

- RCC Loft Over Bathroom for Loft Tank & Storage Area
- Digital Print Technology Wall Tiles Up To Ceiling Height
- Anti-skid Flooring Tiles
- Decorative FRP Doors With Cylindrical Locks
- Black Granite Bathroom Door and windows Frames
- Concealed Plumbing With Anti-corrosive cpvc & upvc pipes
- CP Fittings Of "PLUMBER" Brand
- Branded Sanitaryware CERA/RAK
- One Loft Tank in Each Flat





LAYOUT PLAN

R - ROAD SIDE FLATS  
G - GARDEN FACING FLATS  
B - BACK SIDE FACING FLATS





R - ROAD SIDE FLATS  
G - GARDEN FACING FLATS  
B - BACK SIDE FACING FLATS

## ROSE B & C-WING

GROUND FLOOR PLAN

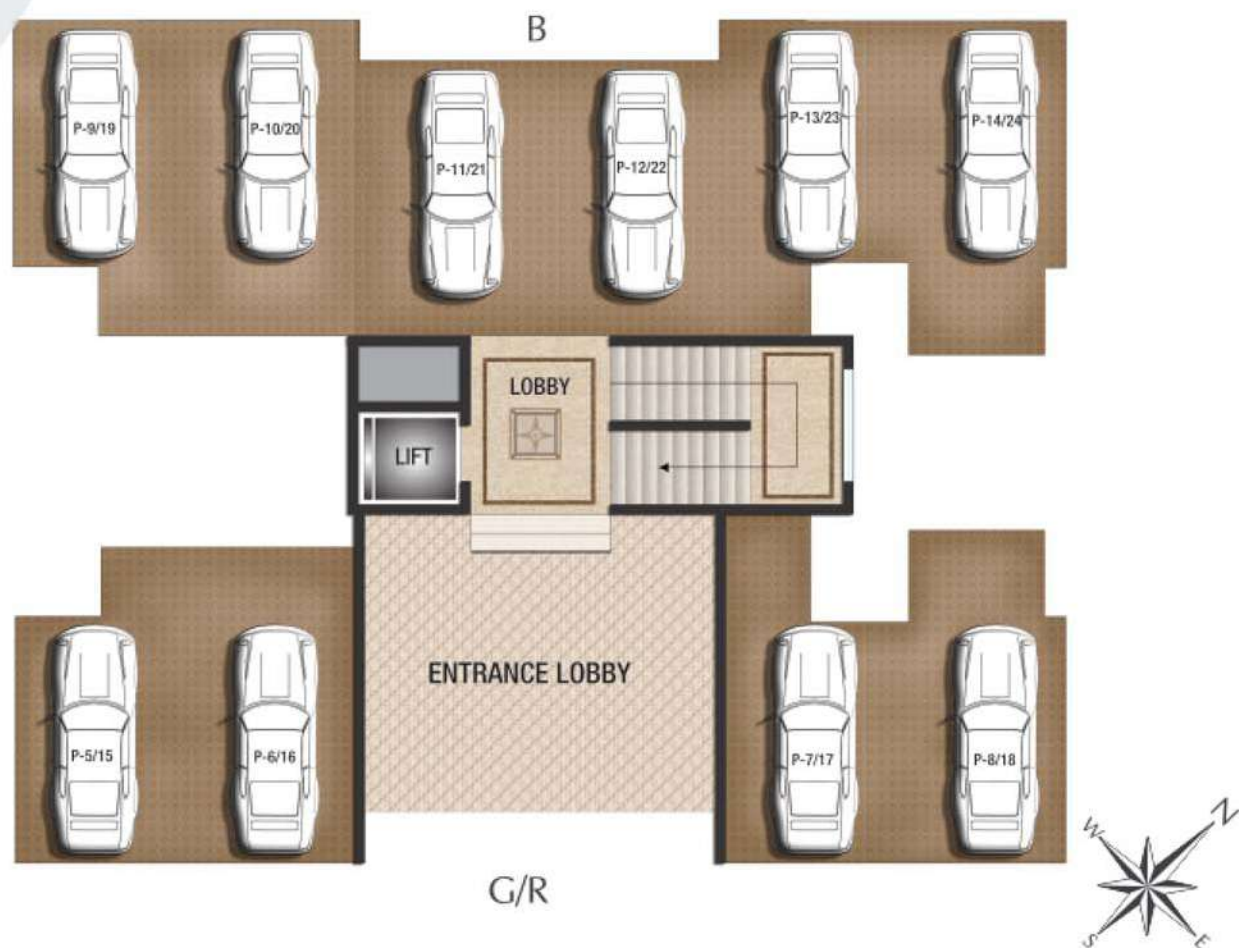

1ST TO 7TH FLOOR PLAN



R - ROAD SIDE FLATS  
G - GARDEN FACING FLATS  
B - BACK SIDE FACING FLATS

## ROSE D-WING

STILT FLOOR PLAN

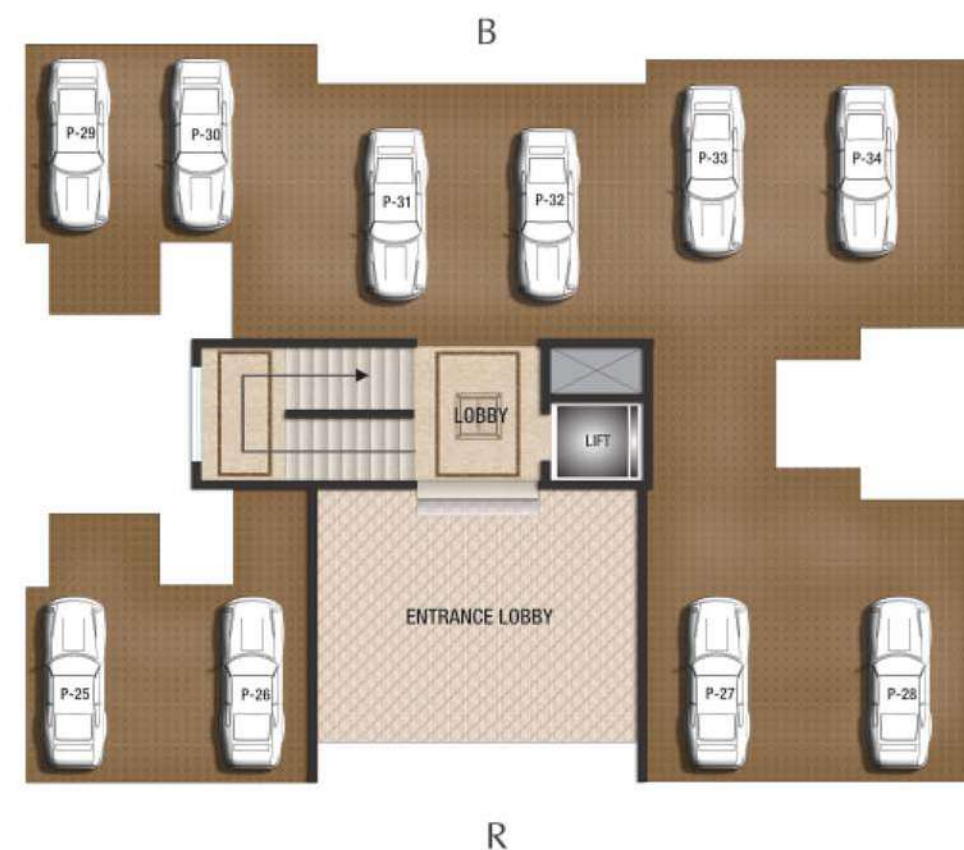

1ST TO 7TH FLOOR PLAN





R - ROAD SIDE FLATS  
G - GARDEN FACING FLATS  
B - BACK SIDE FACING FLATS

## TULIP A-WING

### GROUND FLOOR PLAN



R

### 1ST FLOOR PLAN



R

### TYPICAL FLOOR PLAN(2ND TO 7TH)



R



R - ROAD SIDE FLATS  
G - GARDEN FACING FLATS  
B - BACK SIDE FACING FLATS

## TULIP B -WING

### GROUND FLOOR PLAN



R

### 1ST FLOOR PLAN



R

### TYPICAL FLOOR PLAN(2ND TO 7TH)



R





R - ROAD SIDE FLATS  
G - GARDEN FACING FLATS  
B - BACK SIDE FACING FLATS

GROUND FLOOR PLAN



## TULIP C -WING

TYPICAL FLOOR PLAN(1ST TO 7TH)



R - ROAD SIDE FLATS  
G - GARDEN FACING FLATS  
B - BACK SIDE FACING FLATS

GROUND FLOOR PLAN



## TULIP E -WING

TYPICAL FLOOR PLAN(1ST TO 7TH)



## TULIP D -WING

GROUND FLOOR PLAN



TYPICAL FLOOR PLAN(1ST TO 7TH)



GROUND FLOOR PLAN



## BRIZA A -WING

1ST TO 7TH FLOOR PLAN

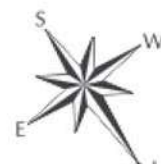



R - ROAD SIDE FLATS  
G - GARDEN FACING FLATS  
B - BACK SIDE FACING FLATS

## BRIZA B-WING

GROUND FLOOR PLAN



1ST TO 7TH FLOOR PLAN



## BRIZA C -WING

GROUND FLOOR PLAN



1ST TO 7TH FLOOR PLAN



R - ROAD SIDE FLATS  
G - GARDEN FACING FLATS  
B - BACK SIDE FACING FLATS

## BRIZA D-WING

STILT FLOOR PLAN



1ST TO 7TH FLOOR PLAN



## BRIZA E & F- WING

STILT FLOOR PLAN

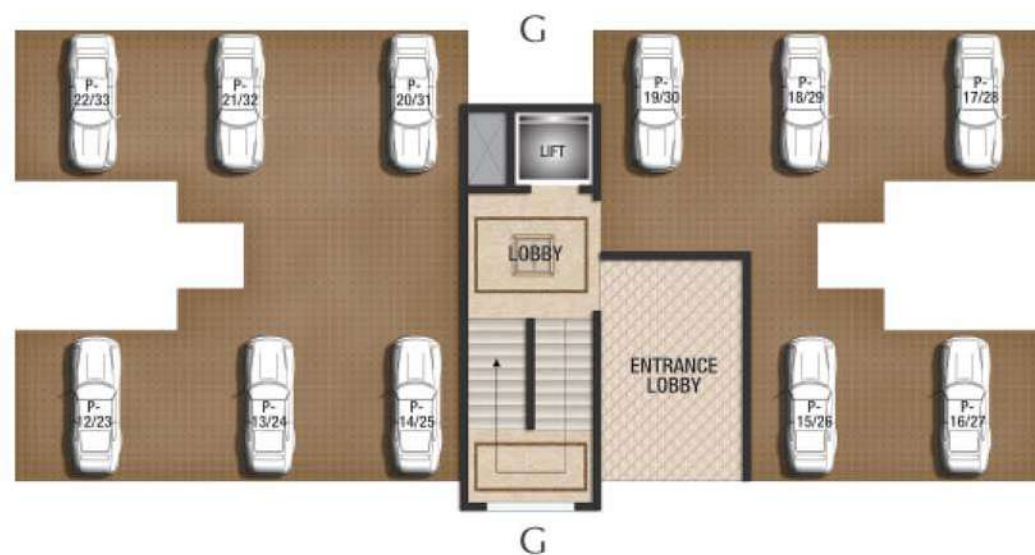

1ST TO 7TH FLOOR PLAN





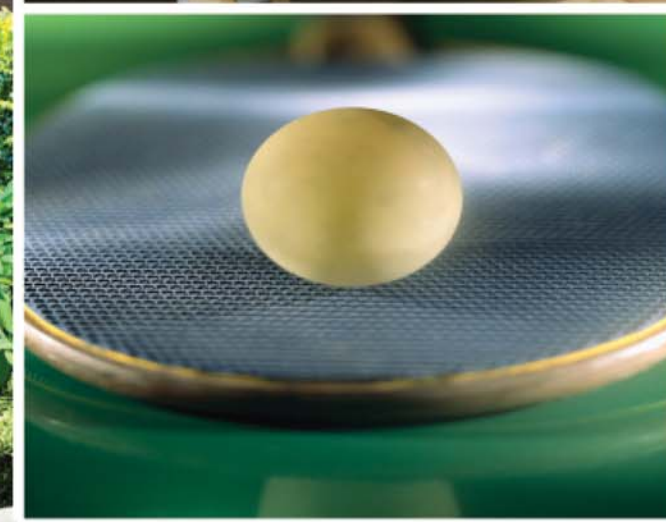
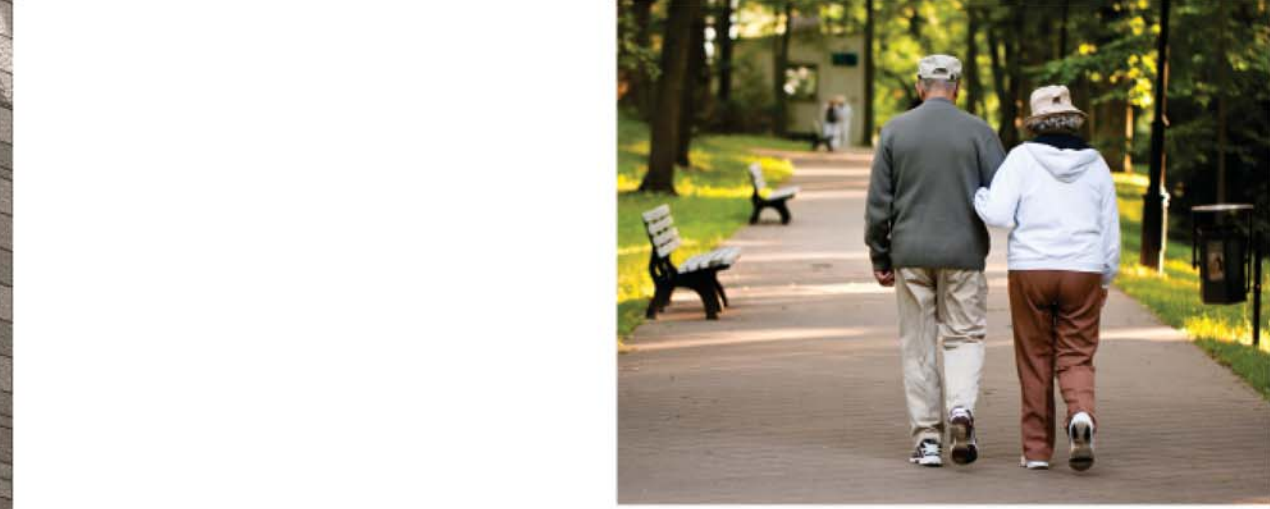





KITCHEN



LIVING ROOM



MASTER BEDROOM



WASHROOM



AERIAL VIEW



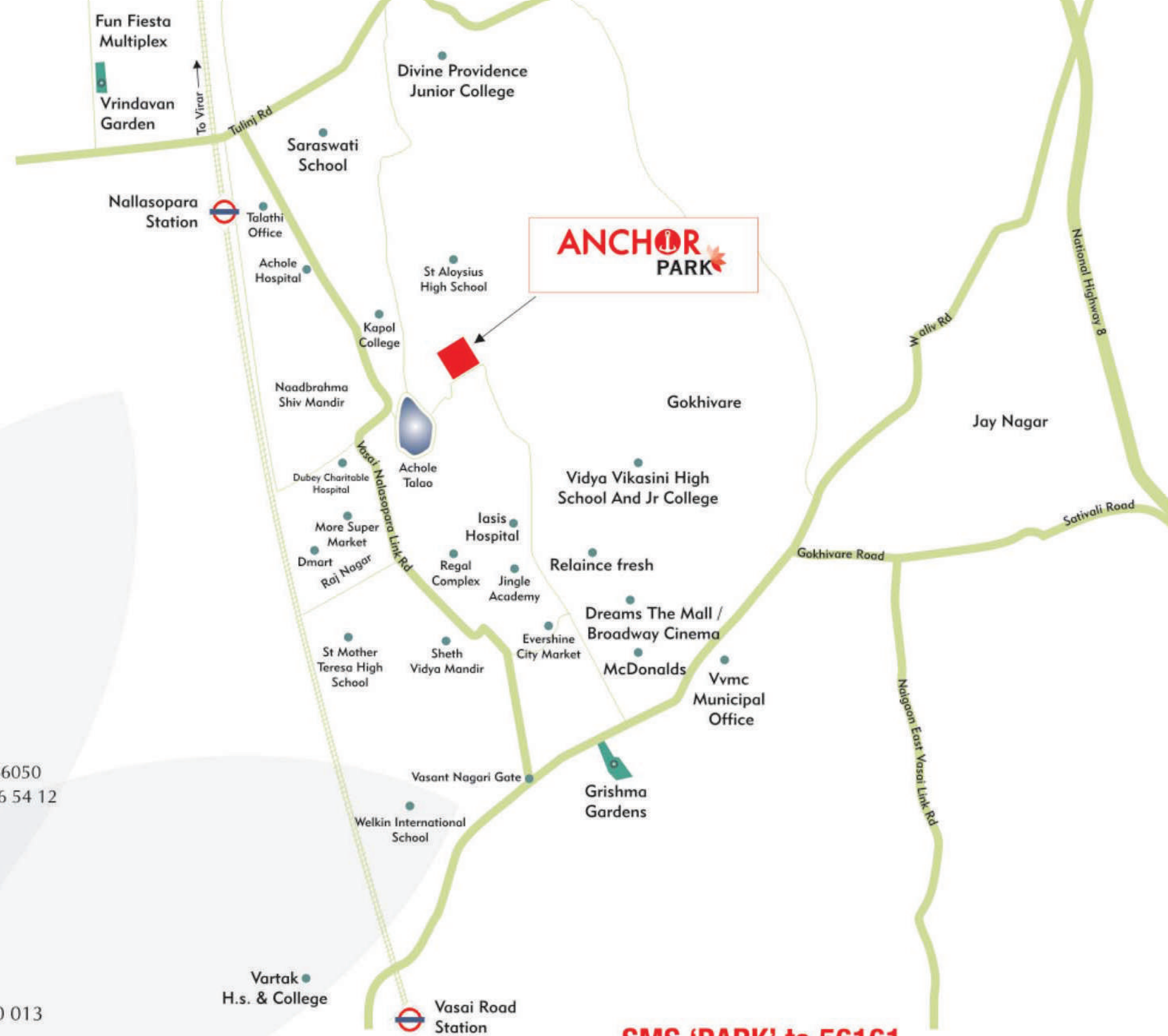

# ANCHOR PARK

**Developer**  
Lakozy Builders LLP.

**Site Address:**  
Anchor Park, Sector- F,  
Evershine City Last Stop,  
Near Achole Talao,  
Vasai (E).  
Tel.: 0250 - 6585060 / 0250 - 6586050  
Contact.: 9004 36 54 10 / 9004 36 54 12

E-mail: [info@anchorrealty.in](mailto:info@anchorrealty.in)  
[www.anchorrealty.in](http://www.anchorrealty.in)

**Corporate Address:**  
Level 13, Tower B,  
Peninsula Business Park,  
Senapati Bapat Marg,  
Lower Parel (W), Mumbai - 400 013  
Tel.: +91 22 3003 6565

**SMS 'PARK' to 56161**

\*Disclaimer:  
The information in this brochure is indicative of the kind of development that is proposed. Subject to the approval of the authorities or in the interest of continuing improvements, the developer reserves the right to change the layout, plans, specifications, features, brands used or amenities without prior notice or obligation. The amenities shown inside the images in the brochure are purely indicative. All amenities, fixtures, brands, tiles etc. mentioned in the brochure OR displayed in the show / sample flats are subject to availability and quality checks of the specific design at the time of execution and implementation.